

USAGE

HAND WRAPPER

1. INSTALLATION

- ① Select plate place to do work
- ② Keep away water or moisture
- ③ Check the using voltage
- ④ Set the film on the back roller and install the film as shown bellow picture.
- ⑤ Set the earth wire for preventing electric shock.
- ⑥ Adjust the tension bolt in order to have elasticity in pulling of the film.

1. FILM OUTSIDE

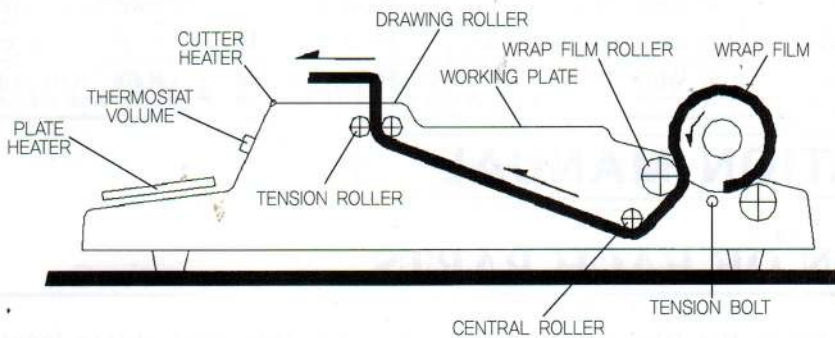

2. FILM INSIDE STYLM

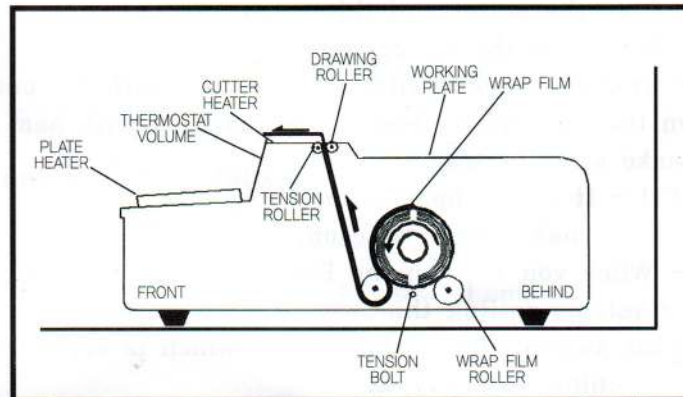

3. SPECIFICATIONS

POWER CONSUMPTION	175W
DIMENSION	470(W) X 600(D) X 100(H)
TEMPERATURE OF H/P	90℃ MAX
VOLTAGE	220V/50 - 60Hz
TEMPERATURE OF H/C	150℃ MAX
WEIGHT	6.5kg
MATERIAL OF USING	PVC, PE WRAP FILM
MAXIMUM SEALING LENGTH	450mm(NW-460),500mm(NW-520) FILM

2. NAME OF EACH PART

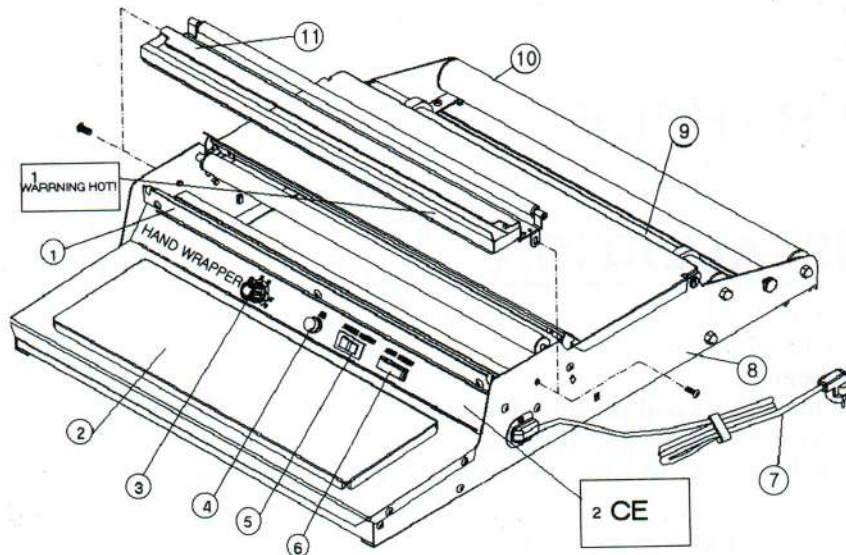

① Heat Cutter	② Heat Plate	③ Heat plate volume switch
④ Fuse holder	⑤ Heat cutter switch	⑥ Heat plate lamp
⑦ Power cord	⑧ Side panel	⑨ Work table
⑩ Roller	⑪ Heat cutter cover	

3. OPERATION MANUAL

1. FUNCTION OF EACH PARTS

- ① **HEAT CUTTER** - When the film pull down with a tray, this heat cutter located inside of heat cutter cover cut the film by electric heat.
- ② **HEAT CUTTER COVER** - Heat cutter cover is covering in order to prevent direct heat from the cutter and this cover has radiation heat from the cutter approximately 113°C
- ③ **HEAT PLATE** - After wrap a tray with film, cut the film with the cutter, lay down the tray on the heat plate and then with heat plate heat, it can make seal the tray.
- ④ **HEAT CUTTER SWITCH** - It makes heat cutter on.
- ⑤ **HEAT PLATE SWITCH** - It makes heat plate on.
- ⑥ **HEAT PLATE LAMP** - When you turn on the Plate switch, this lamp is on and as following the volume setting this lamp will be bright or dark.
- ⑦ **VOLUME SWITCH** - This switch control the voltage which is supplied to the machine from 50V-220V.
When you select volume level. Please refer to below chart.

Volume level	Voltage	Heat plate temperature
1	54V	20°C
2	67V	24°C
3	113V	41°C
4	150V	59°C
5	178V	72°C
6	194V	78°C
7	207V	85°C
8	210V	89°C

HEATER CUTTER TEMP 113°C, 220V one mode

⑧ FUSE

This machine have to be installed by 2A fuse on the name plate, "2A" we marked means 2 ampere fuse.



Use 2A fuse only for this machine.

⑨ WORK TABLE

The goods for wrapping should be set on the work table.



Always use a tray when you wrap a goods
Don't wrap the tray containing water.

⑩ TENSION BOLT

This tension bolt is to have elasticity in pulling of the film.

⑪ CONTROL BOARD

This board controls the voltage that is given by volume level.

2. INSTRUCTION OF OPERATION

- ① Set the tray containing goods or materials on the work table.



Don't use a tray containing water and oil

- ② Draw the wrap film from the gap of work table rollers and cover the tray or material with film.
③ Draw down the wrapped tray to the heat plate. at this time, the heat cutter cut the film by heat automatically.



Do not touch the cutter and cover by hand.

- ④ Put down the tray on the plate and press the tray lightly several times.
⑤ Check the wrapped tray.

4. MAINTENANCE MANUAL

1. REPLACING OF PARTS

- ① Replacing heat cutter

- Release the cutter cover standing screw and take away the cover from cutter
- release the cutter wire holding screw
- pull out the cutter wire from front panel wire
- release new cutter and fasten the screws contrarily

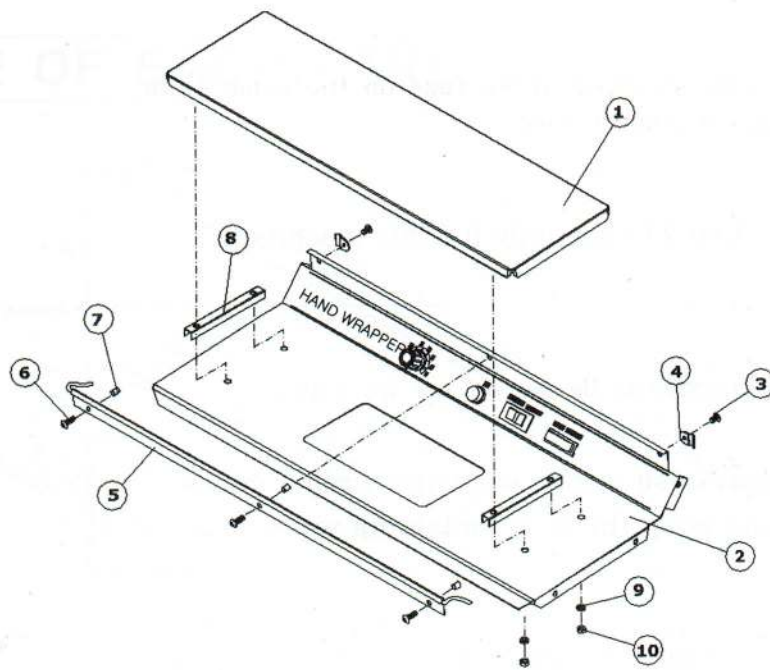

2. CAUSE AND TREATMENT OF PROBLEMS

MALFUNCTIONS	CAUSE	CORRECTION
HEAT PLATE LAMP DOES NOT ON. (Doesn't make seal)	Bad power cord or socket.	Check & replace power cord & socket.
	Heat plate heater wire cut	Change heat plate.
	Bad controller	Ask to A/S center.
	Bad lamp & lamp connector	"
	Fuse gone out.	Change the fuse.
HEAT CUTTER DOES NOT MAKE HEAT. (Doesn't cut film).	Heat cutter cut out.	Change heat cutter.
	Bad lamp.	Ask to A/S center.
CONTROLLER DOESN'T WORK	Over heating.	Ask to A/S center
	Bad controller	"

3. CIRCUIT DIAGRAM

